

A

SPECIALTY LIFTING SYSTEMS



THE **DJS-SERIES** JACK STAND IS DESIGNED TO COMPLIMENT THE DURAPAC SDL LOCKING JACKS.

The DJS-Series Jack Stand is rated and certified to 100 tonne and complies with AS/NZS 2538:2004 standard for vehicle support stands.

A pneumatic assist raises the central piston against the vehicle while the lock nut is wound down by the operator. They can be permanently joined via continuous tine pockets to produce dedicated stands for particular vehicles or applications.



Australian designed and built to meet AS/NZS 2693:2007 standard for vehicle jacks

DJS-1000

Model Number	Load Capacity			Min. Height (mm)	Max. Height (mm)	Base W x L (mm)	Air Pressure Rating (bar)	Max. Rated Height (mm)	Weight (kg)
	Metric (tonne)	US (ton)*	(kN)						
DJS-650	100	110	980	650	900	600 x 600	7	1,100	274
DJS-800	100	110	980	800	1,200	600 x 600	7	1,500	323
DJS-1000	100	110	980	1,000	1,400	600 x 600	7	1,700	370

* Nominal Cylinder Capacity in ton - see kN values for actual capacity

LOCK NUT

is wound down to the housing shoulder to hold load at any position

STAND HEIGHT ADJUSTMENT

is controlled by an internal pneumatic cylinder

EASE OF USE

fork tine pockets and shackle lifting points are provided for ease of use and manoeuvring. A standard Euro style pallet jack can also be used for transport of the stand

3 WAY / 3 POSITION CONTROL VALVE

releases air from cylinder

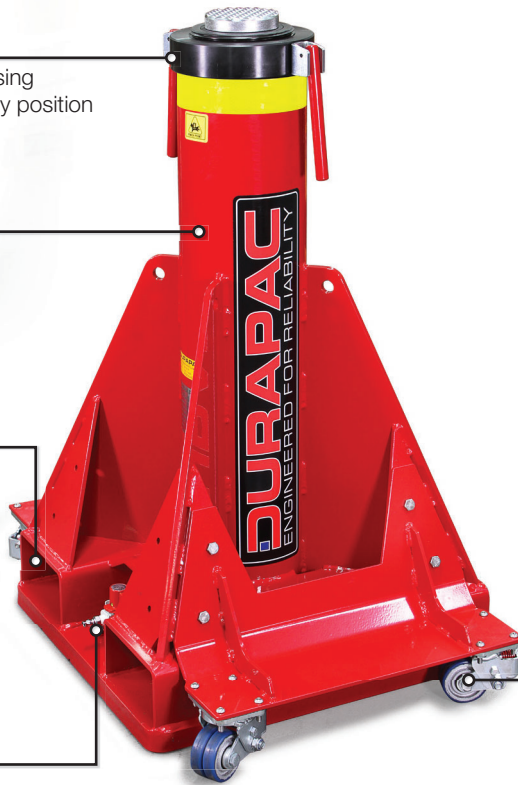

CASTOR WHEELS

Optional Castor Wheels and Steering Handle are available for positioning the Jack Stand



CAPACITY

**100 tonne
(110 US ton)**

MAX. RATED HEIGHT RANGE

1,100 – 1,700 mm

A

SPECIALTY LIFTING SYSTEMS



DJS-1000 with optional Steering Handle and Castor Wheels



Extension storage



Standard SDL extensions, load and swivel load caps may be used. See Page 16 for SD-Accessories

SD-ACCESSORIES

A

SPECIALTY LIFTING SYSTEMS



SDL WITH CUSTOM LOAD CAP

THE SD-ACCESSORIES ARE DESIGNED TO SUIT THE COMPACT **SAFE D LOCK** JACK AND IT'S EXTENDED FAMILY OF JACKS. THIS INCLUDES THE **POWERDRIVE**, EXTRA COMPACT, TALLEST, SLIMLINE & SDN-SERIES JACKS & DJS-SERIES JACK STANDS.

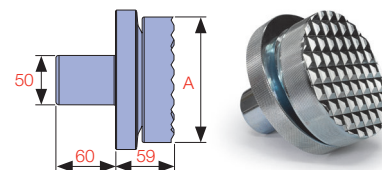

SDS-150/200N

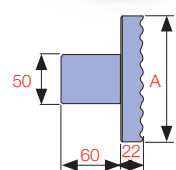

SDLC LOAD CAP

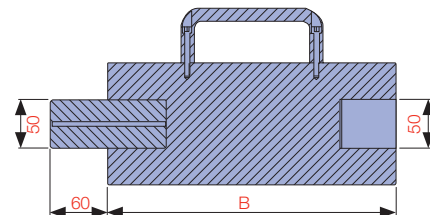

EXTENSION 100 - 500 mm

Model Number	Capacity (ton)	Description	A Diameter (mm)	B Height (mm)	Spigot Depth (mm)	Spigot Diameter (mm)	Weight (kg)	Suits Model(s)	
SDE100-100	70/100	100 mm Extension	126	100	60	50	7	SDL/SDN 70 - 100 ton	
SDE100-150	70/100	150 mm Extension	126	150	60	50	7		
SDE100-200	70/100	200 mm Extension	126	200	60	50	7		
SDE100-300	70/100	300 mm Extension	126	300	60	50	13		
SDE100-400	70/100	400 mm Extension	126	400	60	50	13		
SDLC-100	70/100	Serrated Steel Load Cap*	112	22	60	50	3		
SDS-100N	70/100	Serrated Tilt Saddle	108	50	60	50	5	SDL/SDN 150 ton & DJS Stands	
SDE150-150	150	150 mm Extension	126	150	60	50	7		
SDE150-200	150	200 mm Extension	126	200	60	50	7		
SDE150-250	150	250 mm Extension	126	250	60	50	7		
SDE150-300	150	300 mm Extension	126	300	60	50	13		
SDE150-350	150	350 mm Extension	141	350	60	50	13		
SDLC-150	150	Serrated Steel Load Cap*	126	22	60	50	3	SDL/SDN 150 - 200 ton & DJS Stands	
SDS-150/200N	150/200	Serrated Tilt Saddle	126	59	60	50	5		
SDE200-100	200	100 mm Extension	141	100	60	50	8		SDL/SDN 200 ton & DJS Stands
SDE200-150	200	150 mm Extension	141	150	60	50	8		
SDE200-200	200	200 mm Extension	141	200	60	50	15		
SDE200-300	200	300 mm Extension	141	300	60	50	15		
SDE200-400	200	400 mm Extension	141	400	60	50	15		
SDE200-500	200	500 mm Extension	141	500	60	50	15		
SDLC-200	200	Serrated Steel Load Cap*	126	22	60	50	4		

* Supplied as standard

Custom load caps are available - consult Durapac

